

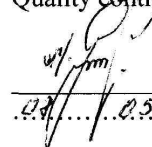

Service Bulletin No. 017AT.7.66.002A

## Engine firewall installation

JSC "Sportinė aviacija"  
Quality control Director

  
G. Nekrašius  
... 05 ... 2007

AB "Sportinė aviacija"  
Design Director

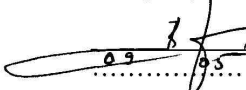
  
K. Juočas  
... 05 ... 2007

AB "Sportinė aviacija"  
Service engineer

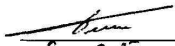
  
K. Gečas  
... 05 ... 2007

2007



<b>JSC “SPORTINĖ AVIACIJA”</b>	<b>Page 3</b>
<b>Service Bulletin No. 017AT.7.66.002 A</b>	<b>Pages 12</b>

**1. Subject:** Installation engine firewall.

The copies of the service bulletin No. **017AT.7.66.002A** are sent to:

1. Civil Aviation Administration of the Lithuanian Republic (CAA) – 1 copy;
2. EASA RP for LAK-17AT, LBA, Germany - 1 copy;
3. Aviation authorities of countries, which issued Type Certificates for the LAK-17AT, 1 - copy;
4. For the known owners of the LAK-17AT or administration of organizations (clubs) having LAK-17AT motor gliders – 1 copy.

**2. Affected:**

**Type:** LAK-17AT

**Manufacture:** AB “Sportinė Aviacija”, Pociūnai, LT-59327 Prienai, Lithuania.

**Serial numbers affected:** For the LAK-17AT serial numbers 107, 109, 138, 140, 141, 147, 149, 151, 152, 153, 156, 157, 158, 163.

**Original type certificate:** EASA Type Certificate A.083 (21 April 2006).

**3. Reason:** Requirement of safety.

**4. Time of compliance:**

This service bulletin must be accomplished immediately after receiving it.

**5. Actions:**

For installation engine firewall you must:

5.1 to mount in the engine bay details: LAK-17AT 66 00 00 01, LAK-17AT 66 00 00 02, LAK-17AT 66 00 00 03, LAK-17AT 66 00 00 04, LAK-17AT 66 00 00 05, LAK-17AT 66 00 00 05-01, (see Sketch LAK-17AT 66 00 00 00 SB, LAK-17AT 66 00 00 01, LAK-17AT 66 00 00 02, LAK-17AT 66 00 00 03, LAK-17AT 66 00 00 04, LAK-17AT 66 00 00 05, LAK-17AT 66 00 00 05-01);

5.2 to dismantle rubber supportes in the engine bay;

5.3 to mount engine firewall to its appropriate place (see Sketch LAK-17AT 66 00 01 00 SB);

5.4 after regulations and correctness position firewall, cut edge top contour. Inspect minimal distance between control rods (see Sketch LAK-17AT 66 00 00 00 SB);

5.5 mark points on the firewall for attachment and drill the holes  $\varnothing 3$  mm (see Sketch LAK-17AT 66 00 00 00 SB);

- 5.6 according firewall holes drill holes  $\varnothing 3$  mm in the arms of attachment;
- 5.7 inspect place for detail LAK-17AT 66 00 00 01 and drill 4 holes  $\varnothing 4,5$  mm in the firewall for fastening nuts LN 29679 AM4 (see Sketch LAK-17AT 66 00 01 00 SB). Inspect minimal distance between rod control sistem of rudder (see Sketch LAK-17AT 66 00 00 00 SB);
- 5.8 in the attachment points of firewall with arms drill holes  $\varnothing 4,5$  mm;
- 5.9 fasten nuts LN 29 679AM4 fixing arms and firewall;
- 5.10 according places for rubbers attachments in the firewall bottom cut out 2 holes  $\varnothing 30$  mm and mount attachments;
- 5.11 to install engine firewall (see Sketch LAK-17AT 66 00 00 00 SB);
- 5.12 inspect minimal distances between rods control system from outside part of engine firewall and between engine from inside part;
- 5.13 inspect clearance between engine firewall and cable LAK-17AT 64 03 03 00 SB.

**6. Mass and balance:** The described actions do not affect C. G. of the glider.

**7. Documentation and materials:**

7.1 “Maintenance manual for the self-sustaining powered sailplane LAK-17AT”	
7.2 Firewall (see Sketch LAK-17AT 66 00 01 00 SB)	1
7.3 Cover (see Sketch LAK-17AT 66 00 00 01)	1
7.4 Side arm (see Sketch LAK-17AT 66 00 00 02)	2
7.5 Front profile angle (see Sketch LAK-17AT 66 00 00 04)	2
7.6 Rear profile angle (see Sketch LAK-17AT 66 00 00 03)	1
7.7 Left rib (see Sketch LAK-17AT 66 00 00 05)	1
7.8 Right rib (see Sketch LAK-17AT 66 00 00 05-01)	1
7.9 Screw DIN 7985-4,8 ZnpAM4x10	14
7.10 Nut 3381A-4 (LN29679 AM4)	10
7.11 Rivet DIN 7337B 3x8	30

<b>JSC “SPORTINĒ AVIACIJA”</b>	<b>Page 5</b>
<b>Service Bulletin No. 017AT.7.66.002 A</b>	<b>Pages 12</b>

**8. Accomplishment and log entry:**

This service bulletin has to be made by certified person. The compliance of this service bulletin must be checked and entered in the glider 's logbook following the operator 's national regulations.



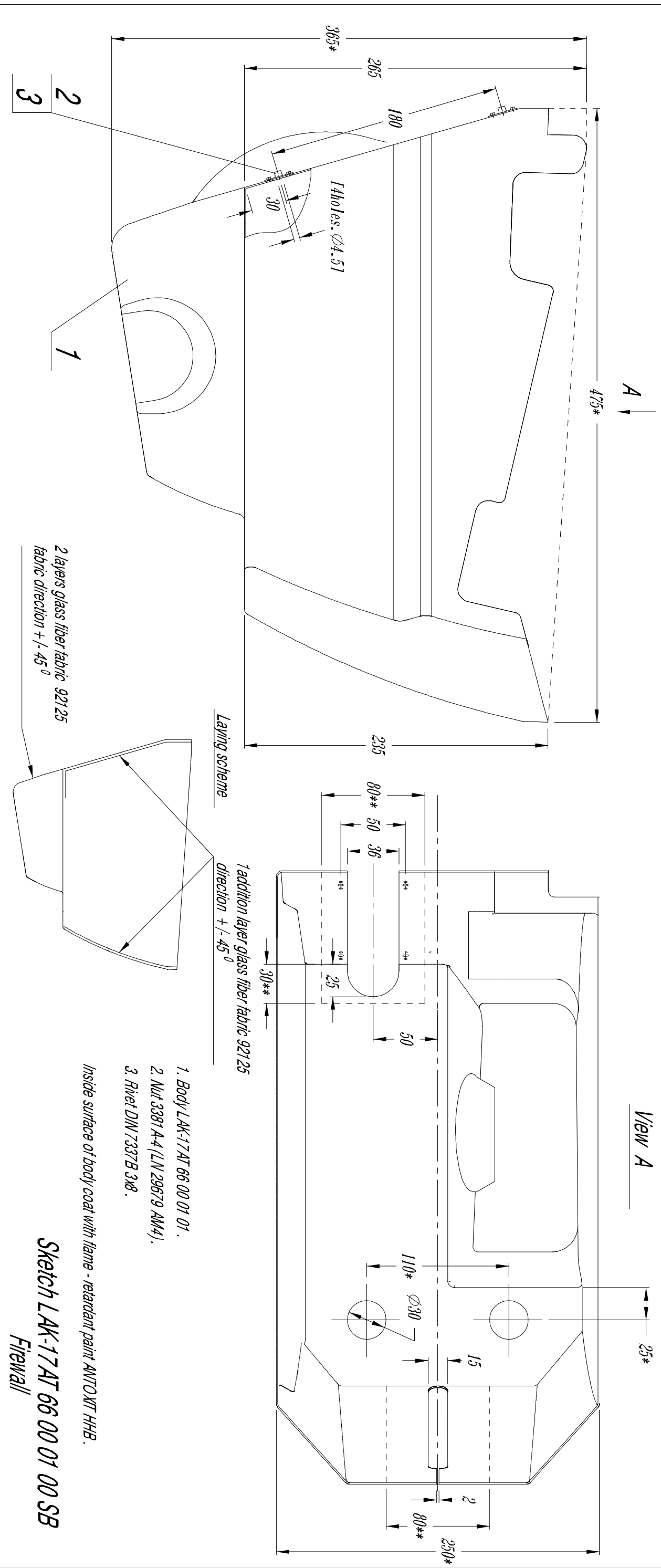

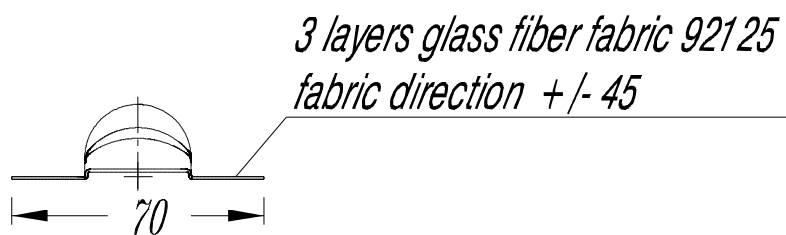
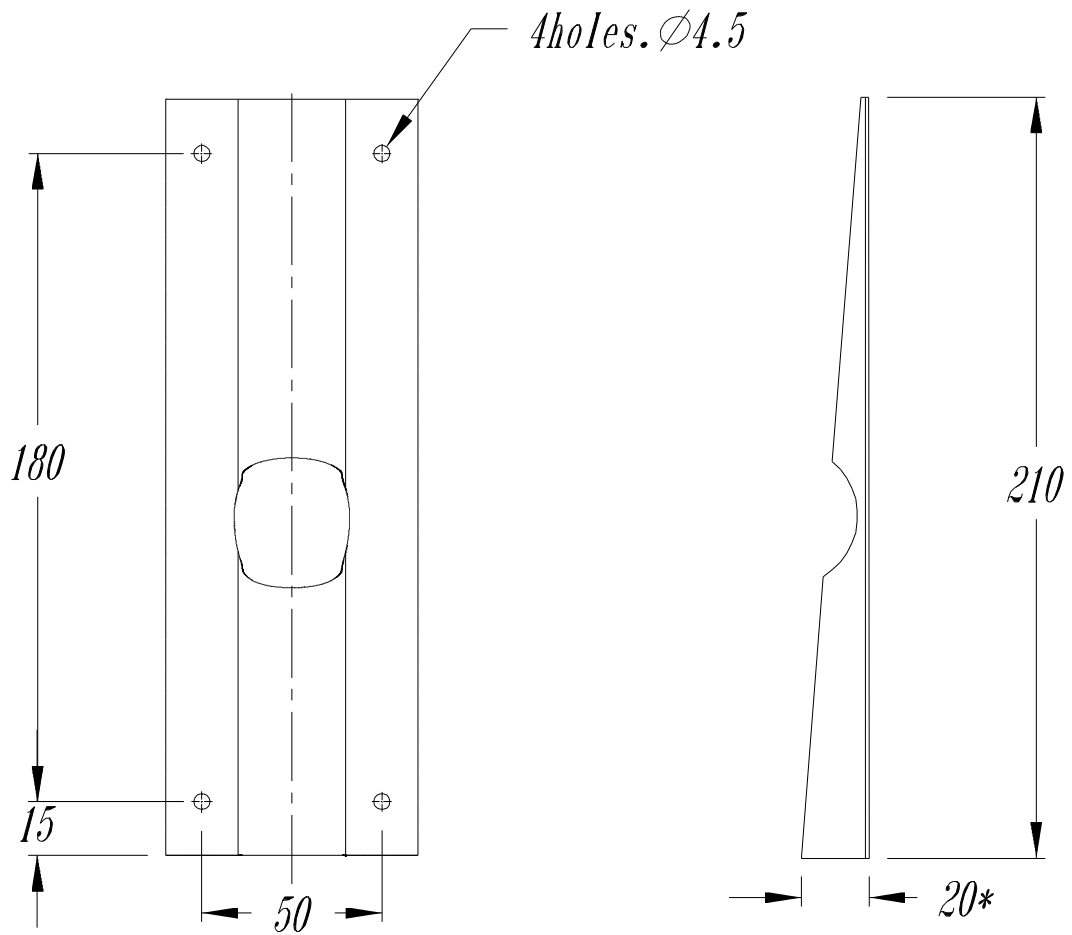

*Sketch LAK-17AT 66 00 00 01*  
*Cover*



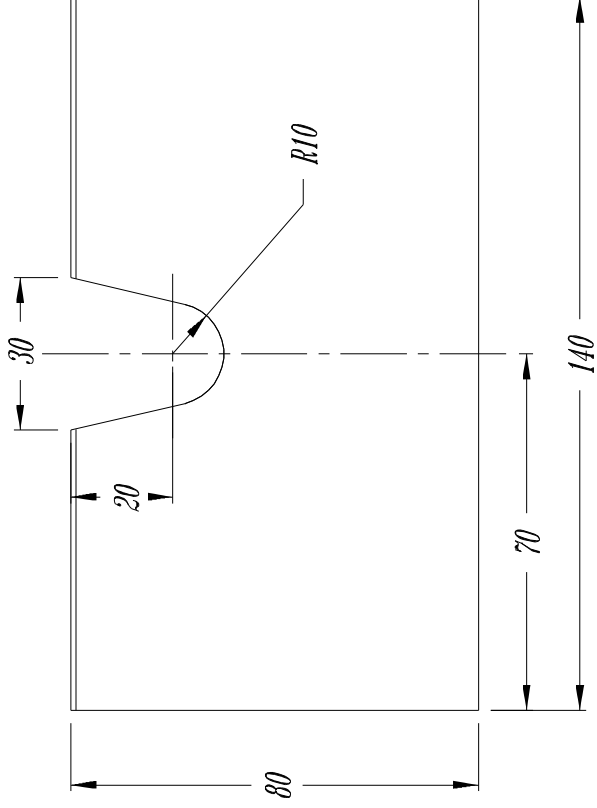
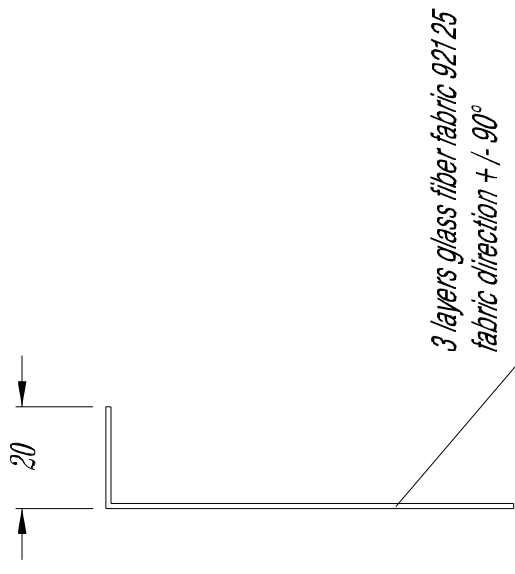

Sketch LAK-17 AT 66 00 00 02

Side arm



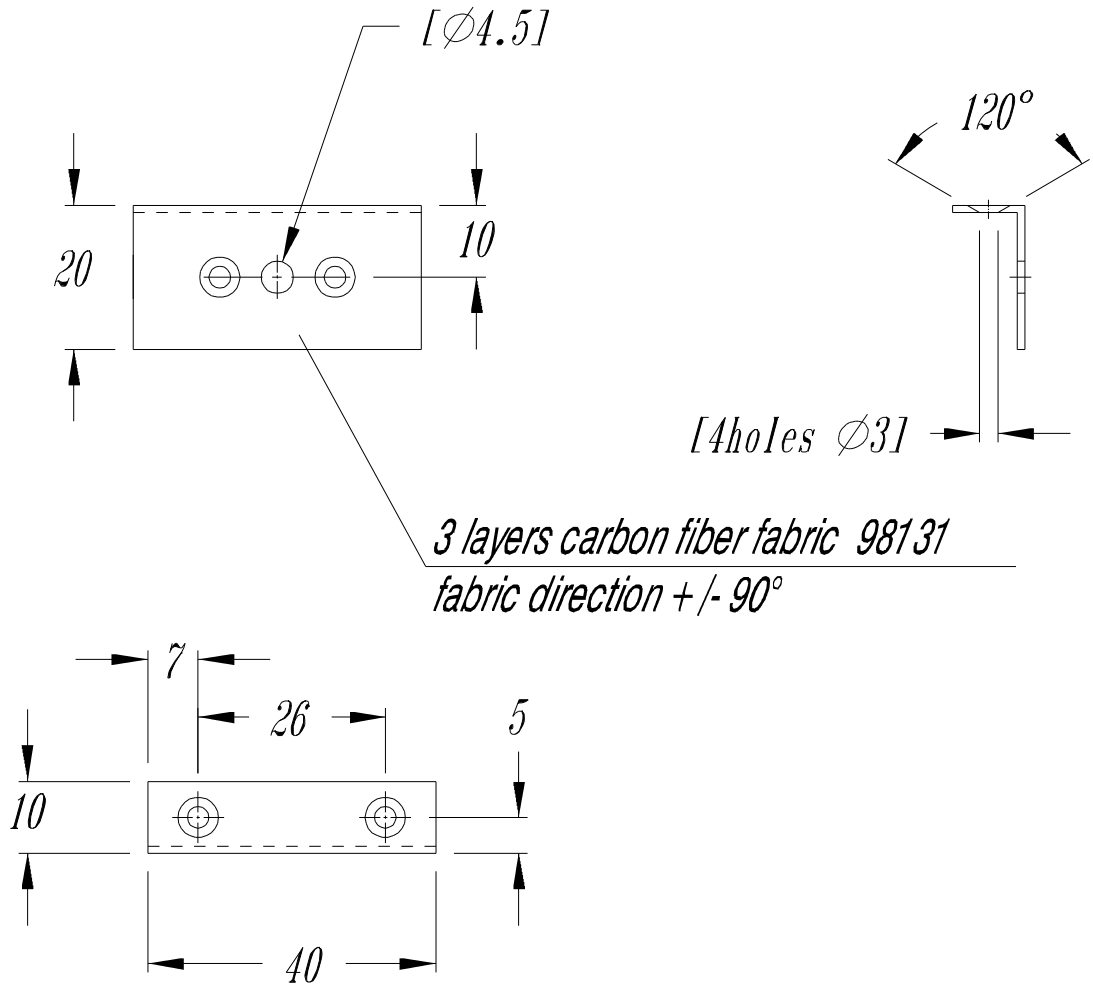

*Sketch LAK-17AT 66 00 00 04*

*Front profile angle*

LAK 17AT 66 00 01 05 -left is shown.

LAK-17AT 66 00 01 05-01 -right symmetric part.

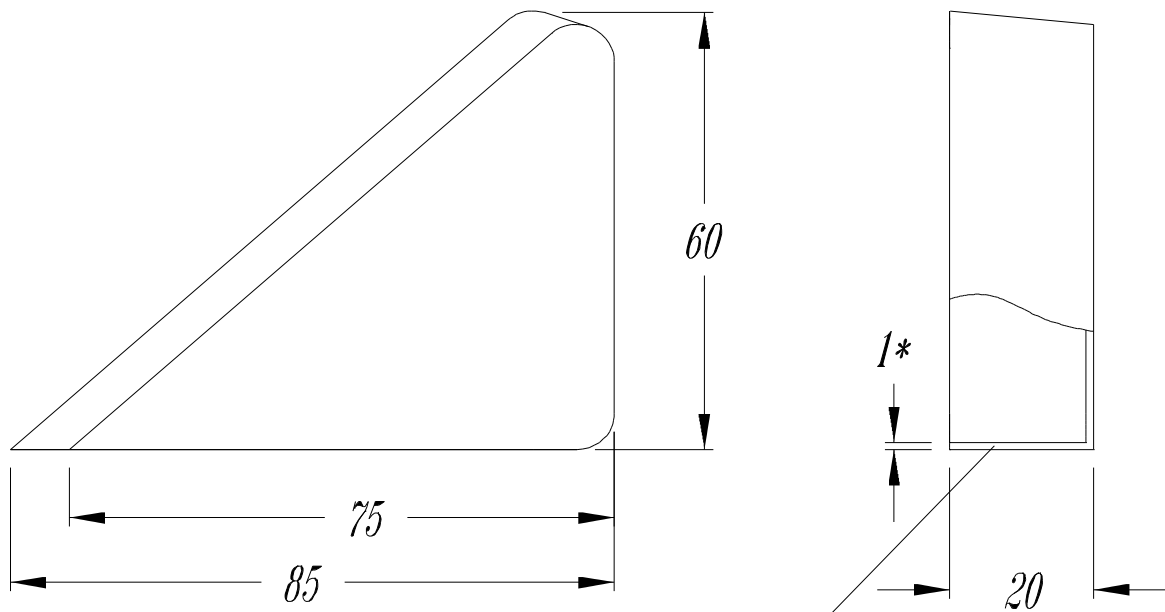

3 layers glass fiber fabric 92125  
fabric direction +/- 45

Sketch LAK-17AT 66 00 00 05

Left rib